

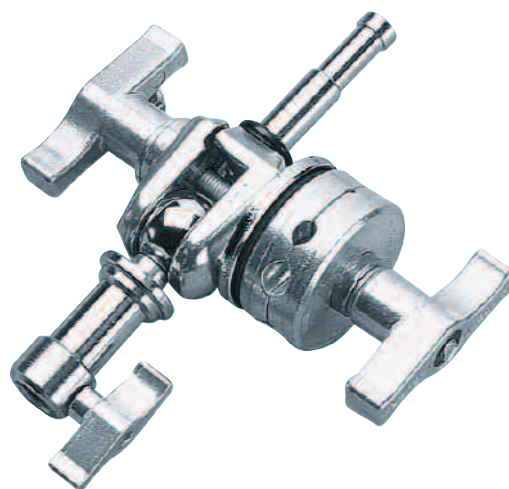

Grip Head System

Specifically designed to position and hold ARRI scrims and flags, floppies, cutters, dots and fingers. The simple, efficient concept behind grip clamps and dedicated arms allows you to support all light control accessories, while the special construction and the variety of available options let you stop, bounce and soften lights in every position you could need.

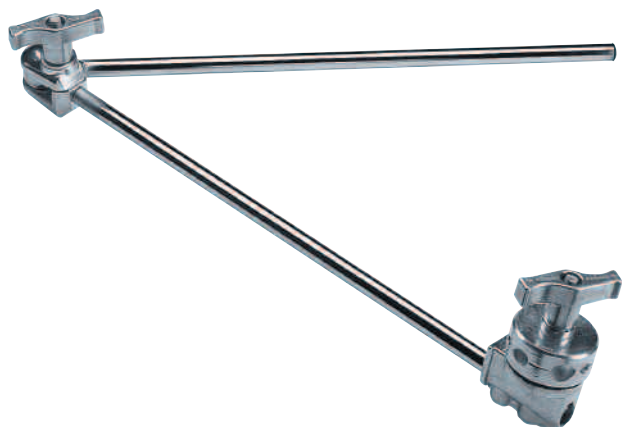

Grip Head System

The perfect grip for your light modification accessories.

- Our Grip Heads have been specifically designed to hold scrims, flags, floppies & cutters mounted on Century stands, or butterfly frames mounted on overhead stands during film, video or photo shoots.
- Extension offset arms, used in combination with Grip Heads, provide an extended grip point for scrims, flags and small lights, and are available in two lengths: 20" (51cm) and 40" (102cm).
- The Grip Head can be combined with other accessories to solve most light and light modification accessory positioning problems.
- Grip Heads are available in two specific diameters, the standard is 2 1/2" (8mm) the Jumbo version is 4 1/2" (10mm).

L2.88175.0 / LD.2030.A

SUPER CLAMP GRIP HEAD (BLACK)

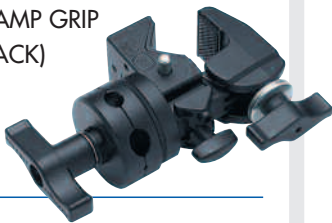

W 0.95kg

Like the LD.2010.A, this kit includes the LD.2000.A Grip Head and the LS.035 Super Clamp.

L2.88176.0 / LD.2040.A

GRIP HEAD WITH SWIVEL PIN

W 1.25kg

Two famous accessories connected together to assure a wide range of fixing solutions. Attachments: 16mm male pin + 16mm female socket 28mm male pin.

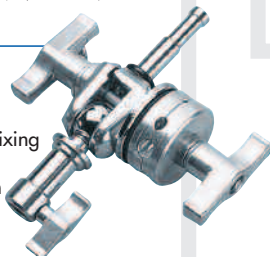

L2.88171.0 / LD.1000.A

DOUBLE GRIP HEAD

W 0.87kg

A combination of two sets of gripheads discs mounted on a steel plate with a 10mm rod.

Attachment: 10mm x 135mm rod.

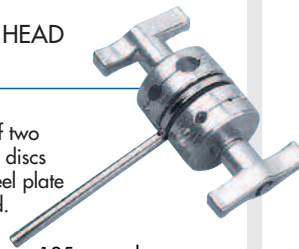

L2.88173.0 / LD.2010.A

SNAP-IN GRIP HEAD

W 0.63kg

Combining the multi-functional LD.2000.A Grip Head with a hex pin to interface with the original Super Clamp. The LD.2010.A allows you to hang flags and scrims in positions that light stands can't reach.



L2.88177.0 / LD.2050.A

GAG GOBO

W 0.46kg

This unique double Grip Head system provides the flexibility of a second grip head allowing hundreds of uses including doubling up scrims and flags.



L2.88172.0 / LD.2000.A

2 1/2" GRIP HEAD

W 0.55kg

U 16mm

ARRI's most popular grip accessory. The LD.2000.A Grip Head has hundreds of functions. Unlike any other grip head, the LD.2000.A utilizes a series of washers for extra locking torque and the use of automotive-quality brake pad discs for secure, non-slip security.

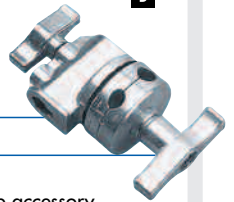

L2.88174.0 / LD.2020.A

GRIP HELPER

W 1.1kg

I Type 33

Just as the name suggests, the Grip Helper is like three Grip Heads in one. Two independent grip heads sandwich a third with a fixed 16mm pin. This system allows multiple light control accessories to mount in front of fixtures without the need for numerous light stands.

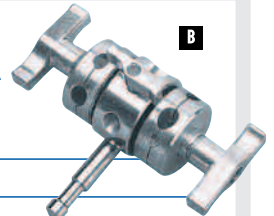

L2.88178.0 / LD.2060.A

ADDAHEAD

W 0.52kg

Like the LD.2030.A, but available as a separate unit. The Addahead provides quick application of a Grip Head into the Super clamp system.

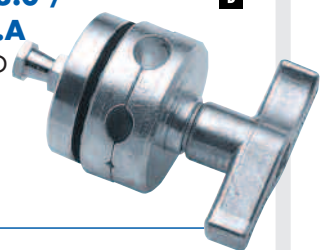

- The 2 1/2" (8mm) version slotted disc accepts round tubes of 8/10/13/16mm diameter and square tubes from 5mm to 8mm diameter.
- The Jumbo 4 1/2" Grip head slotted disc accepts round tubes of 10/13/16/25mm diameter.
- All Grip Heads are equipped with special non slip grip pads for secure and precise control.

L2.88977.0 / LD.050

SET OF 6 BLUE T-TOPS

Rubber cover gives better grip for 80mm T-handles, even in cold weather.

Available also in the following colours:
 Red – code LD.050R
 Yellow – code LD.050Y
 Green – code LD.050G
 Light Blue – code LD.050LB
 Black – code LD.050B



L2.88191.0 / LD.5020.A

40" EXTENSION GRIP ARM

📦 1.6kg

Normally used in combination with a Grip head LD.2000.A it provides an extended grip point for scrim and flags or small lights. Pipe length 1020mm.



L2.88189.0 / LD.5000.A

20" EXTENSION GRIP ARM

L2.88190.0 / LD.5010.A

20" EXTENSION ARM WITH GRIPHEAD

L2.88192.0 / LD.5030.A

40" EXTENSION ARM WITH GRIPHEAD

L2.88186.0 / LD.4010.A

JUMBO ADDAHEAD

📦 0.9kg

Like the smaller LD.2060.A version, this Jumbo Addahead allows you to support lightweight overheads utilizing the Super Clamp system.

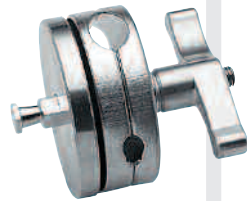

L2.88185.0 / LD.4000.A

4 1/2" JUMBO GRIP HEAD

📦 2.35kg

📏 28mm

🔧 Type 35

Designed to convert a Junior Stand into an overhead stand, the LD.4000.A incorporates a 4-1/2" (10mm) grip head with a junior stud and receiver.

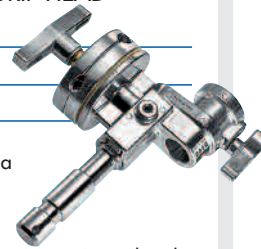

L2.88193.0 / LD.5050.A

FUN GRIP ARM

📦 1.35kg

Normally used in combination with a Grip head LD.2000.A it provides an extended grip point for scrim and flags. Pipe length 510mm.

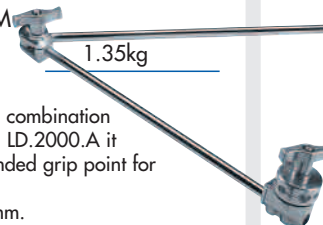

L2.88187.0 / LD.4020.A

JUMBO GAG GOBO

📦 1.3kg

This double 4-1/2" (10mm) Grip Head allows for multiple overheads to be used simultaneously.

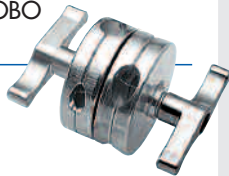

L2.88188.0 / LD.4030.A

JUMBO GRIP HELPER

📦 1.9kg

A combination of two set of grip heads discs mounted on an aluminium plate with a 16mm rod.

Attachment:
16mm x 150mm rod.



L2.88203.0 / LD.8000.K

GRIP KIT

Set of accessories that work on their own or in combination with stands to support scrim, flags and lighting fixtures to provide precision and secure control.

Kit comprises of:
 Black grip head.
 Snap-in 16mm pin.
 Black 40" extension arm.
 Black Super Clamp.
 Grip Kit bag.



L2.88213.0 / LE.6000.A

SNAP-IN PIN

Specifically designed to connect Grip Head to Super Clamp LS.035. Aluminium.

